

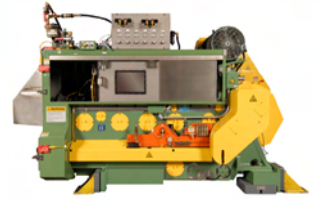

Diamond Linkage Upgrade

For the Stolle Ragsdale Bodymaker
April 2009



In reviewing maintenance records of Ragsdale Bodymakers, the Stolle CMD Aftermarket team discovered that 70% of Diamond Linkage failures could be traced directly to failures in the ankle shaft bearing. Stolle has designed a new ankle shaft bearing assembly to prevent premature linkage failure and increase the time between maintenance intervals.

The main component of the new design is a larger roller bearing for the ankle shaft joint. The bearing diameter has been increased by 13% and the width by 40%, which results in a 67% increase in its load carrying capacity.

An ankle shaft upgrade kit is available to retrofit existing Diamond Linkages to the new improved design (part number 222010513). The upgrade kit consists of:

- Ankle shaft
- Rocker link
- Heavy duty roller bearing
- Associated hardware

Please contact Stolle CMD at 303-708-9044 for more information or to order the Diamond Linkage ankle shaft bearing upgrade kit.

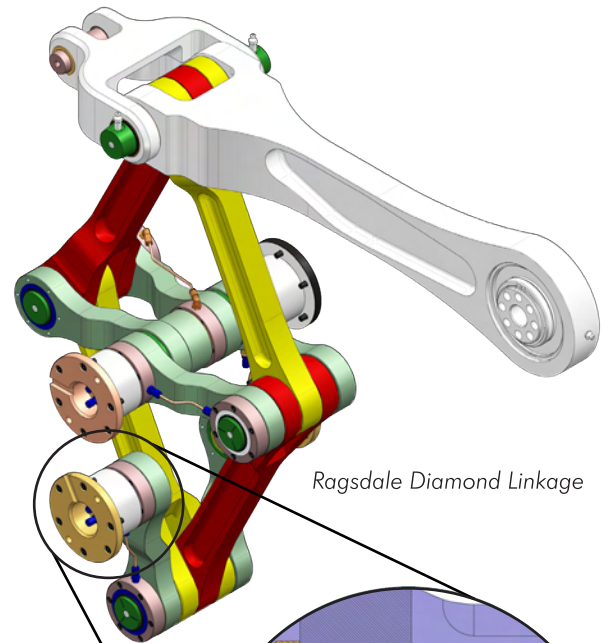

Ragsdale Diamond Linkage

Cutaway of upgraded ankle shaft assembly showing larger roller bearing and rocker link

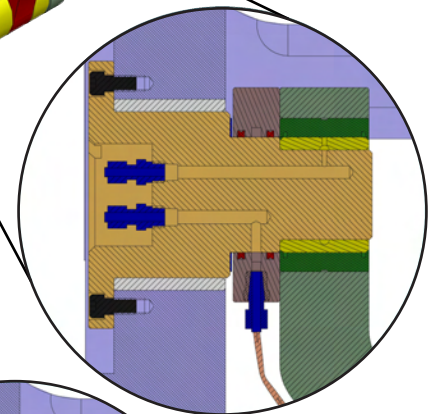

Previous ankle shaft assembly

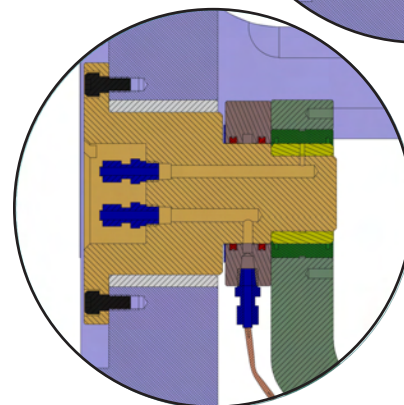

Stolle Machinery Company - Can Machinery Division
6949 South Potomac Street, Centennial, CO 80112
Phone: 303-708-9044 Fax: 303-708-9045
www.stollemachinery.com

Copyright 2009 Stolle Machinery Company, All Rights Reserved

Systems Spares Service Support
StollePlus
For The Life of Your Equipment