

# Improved Blanket Cylinder Main Drive System

for the Stolle Rutherford Decorator

## Stolle Rutherford Decorator

Technical Update 1109-1

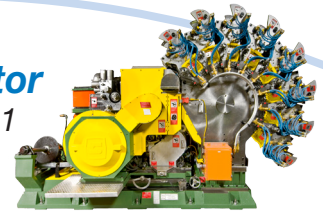

Stolle has redesigned the blanket cylinder main drive system for Rutherford Decorators to improve the durability of the unit. On the transmission block, the shaft, bearings and housing have all been increased in size, and the speed of the shaft was decreased for improved performance of the bearings. In addition, a new type of bearings (double row spherical type) which are now used can handle a much bigger load from the main motor belt. With these changes, the performance of the blanket cylinder drive system is improved and machine downtime will be reduced.

The improved blanket cylinder main drive system is now standard on all new Rutherford 8 color decorators, and is available as a retrofit for any 8 color machine running at speeds of 2,200 CPM and is driven from the blanket side of the decorator.

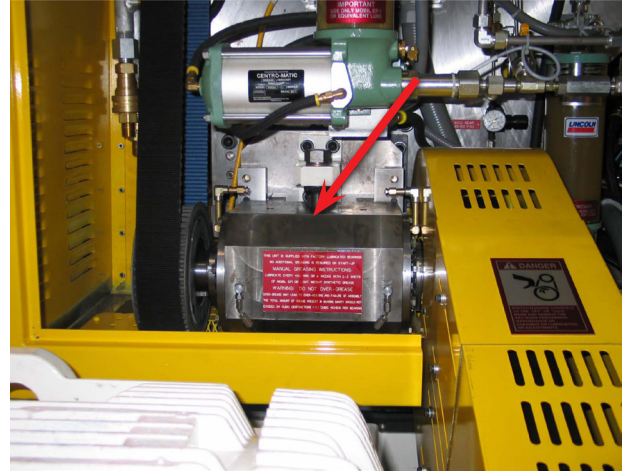

Improved blanket cylinder main drive system installed on a Rutherford 8 color Decorator

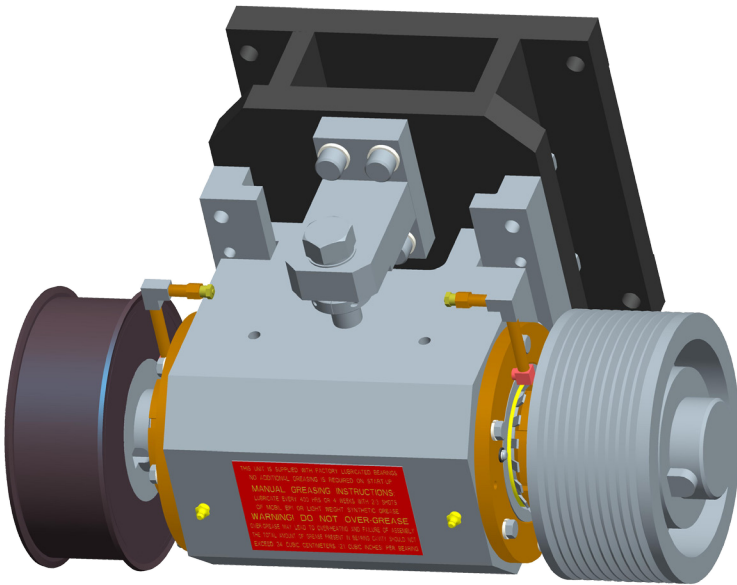

For more information and pricing on the improved drive system retrofit for Stolle Rutherford Decorators, please contact Mark Santos at Stolle at +1 303-708-5173 or [mark.santos@stollemachinery.com](mailto:mark.santos@stollemachinery.com).



**Stolle Machinery Company, LLC**

6949 South Potomac Street, Centennial, CO 80112

Phone: +1 303-708-9044 Fax: +1 303-708-9045

[www.stollemachinery.com](http://www.stollemachinery.com)

A constant flow of innovations, technology and ideas that benefit customers.